

# MODULAR ROOFTOP HELIPORT PLAN

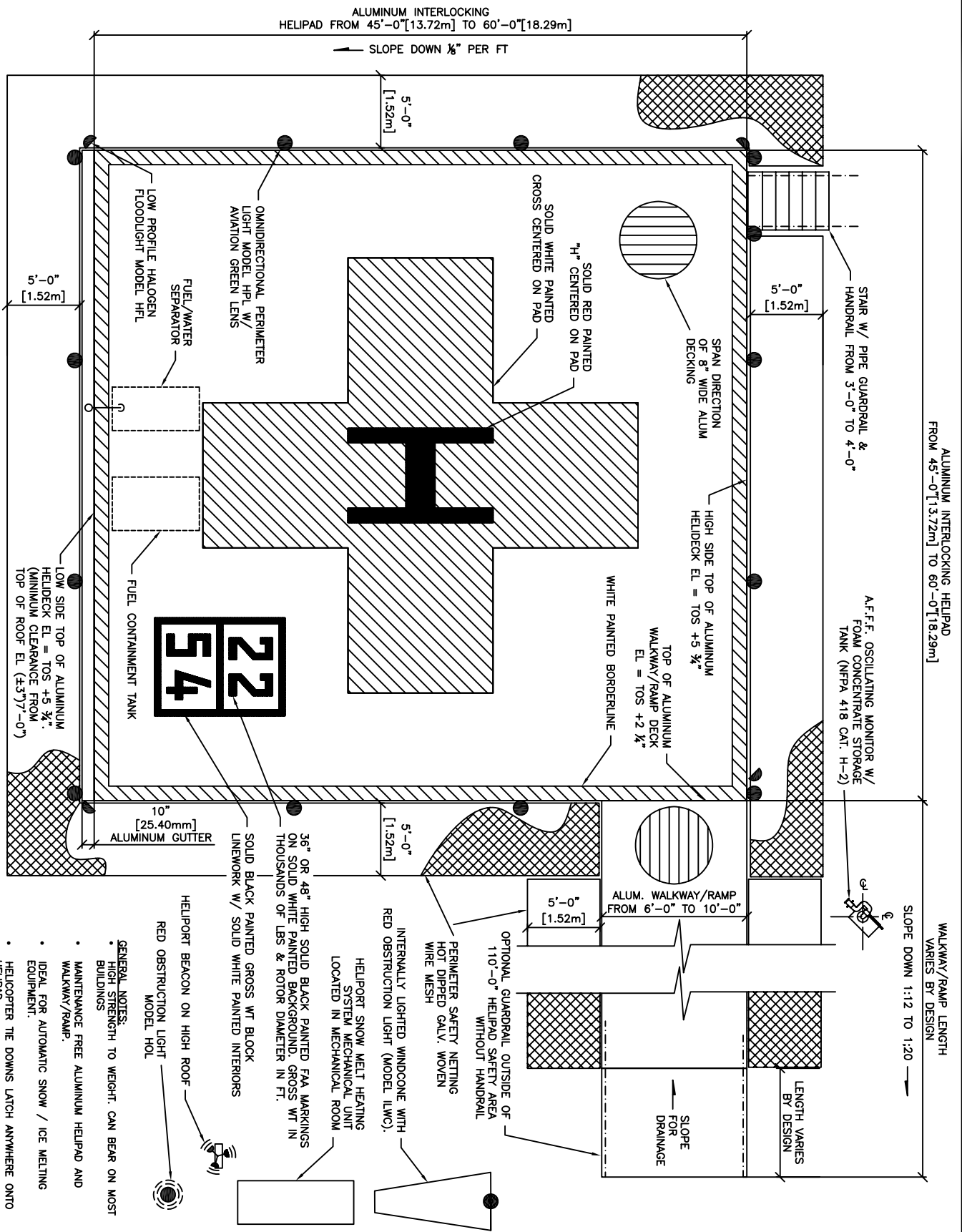

## DESIGN CONSIDERATIONS:

1. CRANE LOCATION(S) MUST BE CONSIDERED BY THE ARCHITECT, OWNER, AND OWNERS REPRESENTATIVE AND SUBMITTED TO HELIPORT SYSTEMS FOR REVIEW PRIOR TO THE DESIGN OF THE HELIPORT.
2. CLEARANCES FOR THE DRAINAGE SYSTEM, STEEL AND ROOF ELEVATIONS, AND LINE OF SIGHT MUST BE CONSIDERED AND SUBMITTED TO HELIPORT SYSTEMS PRIOR TO THE DESIGN OF THE HELIPORT.
3. A PREMIUM WILL BE ACCESSED IF THESE CONSIDERATIONS HAVE NOT BEEN ADDRESSED PRIOR TO THE DESIGN OF THE HELIPORT.

## PLAN NOTES:

1. RAMP FOR HOSPITAL ONLY. SECOND STAIR REQUIRED FOR ALL OTHER HELIPORTS.
2. PAINTED RED H AND WHITE CROSS FOR HOSPITAL ONLY. PAINTED WHITE H FOR ALL OTHER HELIPORTS.

## GENERAL NOTES:

- HIGH STRENGTH TO WEIGHT. CAN BEAR ON MOST BUILDINGS
- MAINTENANCE FREE ALUMINUM HELIPAD AND WALKWAY/RAMP.
- IDEAL FOR AUTOMATIC SNOW / ICE MELTING EQUIPMENT.
- HELICOPTER TIE DOWNS LATCH ANYWHERE ONTO HELIPAD.
- 6 MEN CAN INSTALL HELIPAD IN 5 DAYS IN ANY WEATHER, 8 DAYS WITH SNOW / ICE MELTING EQUIPMENT, AND 10 DAYS WITH LONG RAMPS.



# HELIPORT SYSTEMS INC.

55 Madison Avenue Suite 150  
 Morristown, NJ 07960 USA

Voice 1-973-540-0011  
 Fax 1-973-540-0131  
 E-mail info@heliport.com  
 Web www.heliport.com